

**SERVICE MANUAL**  
**IsoBar 5-120, 6-110 og 8-**  
**100**

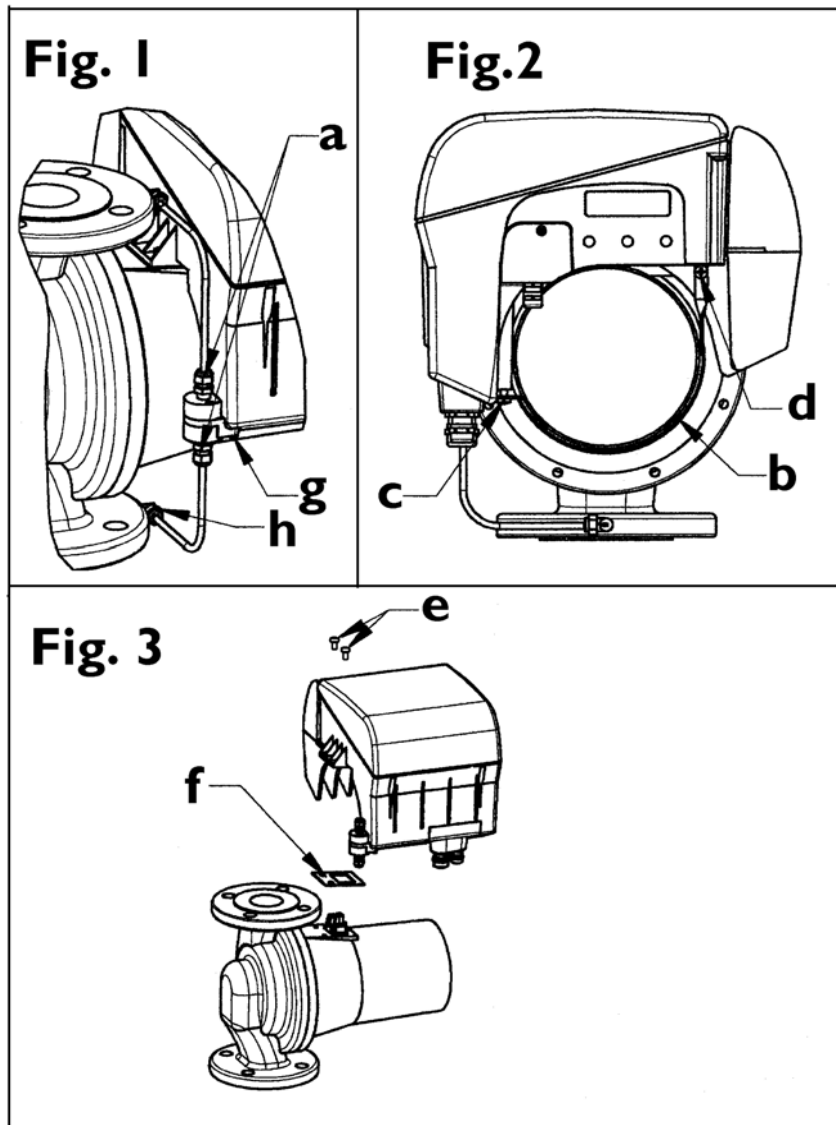

CE

**SMEDEGÅRD**  
 OF DENMARK

T. Smedegaard A/S.  
 Sydvestvej 57 - 59 2600 Glostrup  
 Tel. +45 43 96 10 28, Fax +45 43 63 17 66  
 E-mail: [info@smedegaard.dk](mailto:info@smedegaard.dk)  
[www.smedegaard.com](http://www.smedegaard.com)

Smedegaard Pumps • Unit 7 Barhams Close • Wylds Road  
 Bridgwater • Somerset • TA6 4 DS • England  
 Tel 01278 458686 • Fax 01278 452454  
 E-mail: [smedegaardpumps@btinternet.com](mailto:smedegaardpumps@btinternet.com) •  
[www.smedegaard.com](http://www.smedegaard.com)

**SMEDEGÅRD**  
 OF DENMARK

## SERVICE MANUAL for: IsoBar 5-120,6-110,8-100

This manual describes replacement of :

1. Terminalbox
2. Pressuregauge
3. Pressurepipes
4. Motorkit
5. Position of terminal box

**It is recommended that all work is carried out by authorized personal.**

### Security:



- The surface of the pump might be hot.
- Venting of the pump could result in a slight escape of hot water or steam.



- All electrical supplies must be switched off before service.

### 1. Replacement of terminal box

#### Dismounting:

1. Switch off supply 10 min. before beginning.
2. Close isolation valves on both sides of the pump.
3. Dismount supply cable from terminalrow. Make sure that all wires are switch off. External systems may also be disconnected if so equipped.
4. Pressurepipes on pressuregauge can now be unscrewed (a). Avoid unscrewing of fittings in the pressuregauge by holding fittings (fig.1. Bend pipe to the side. (Take care water might be hot).
5. Dismount retainer (b) by loosening the screw (c) and then unscrewing screw (d) (fig. 2).

6. Dismount the two screws (e) and pull of the terminalbox in the same direction as the screws (fig. 3).

#### Mounting:

1. Check that the gasket (f) is ok.
2. Carefully press the terminalbox over the motorconnector by aligning with the holes for the screws (e).Mount screws (e) .
3. Mount the retainer (b) with th e two screws (c og d).
4. Fit the pressurepipes in place and tighten securely.
5. Mount supply cable and other external wires as they where before (see installation guide for IsoBar).
6. Use the instructions in the installation guide to make the pump ready for service.

### 2. Replacement of pressuregauge

#### Dismounting / mounting: (ESD precautions must always be taken)

1. Switch off supply 10 min. before beginning.
2. Close isolation valves on both sides of the pump.
3. Dismount supply cable from terminalrow. Make sure that all wires are switch off. External systems may also be disconnected if so equipped.
4. Pressurepipes on the pressuregauge can now be unscrewed (a). Avoid unscrewing of fittings in the pressuregauge by holding fittings (fig.1). Bend pipe to the side. (Take care water might be hot).
5. Dismount the screws (g) and carefully pull out the pressuregauge untill connectorplug can be disconnected (fig. 1).

6. *If this connector is missing the wire must be cut 5 cm. from the pressuregauge. Likewis cut the wires on the new pressuregauge. Remove isolation on the wires and connect the wires with butt splice. Make sure the colors correspond.*
7. The pressuregauge can now be pushed into place in the terminalbox and secured with the screws (g) (fig. 1).
8. Fit the pressurepipes in place and tighten securely.
9. Mount supply cable and other external wires as they where before (see installation guide for IsoBar).
10. Use the instructions in the installation guide to make the pump ready for service.

### 3. Replacement of pressurepipe.

1. Switch off supply 10 min. before beginning.
2. Close isolation valves on both sides of the pump.
3. Pressurepipes on the pressuregauge can now be unscrewed (a) and (h). Avoid unscrewing of the fittings in the pressuregauge by holding fittings (fig.1). (Take care water might be hot).
4. Fit new pipes to the old ones. Always replace ferrules with new ones.
5. Check pressure and suction side for right connection if the pumping direction has been changed. The pressuregauge is marked with +/- pressure/suction side.
6. Adjust pressurepipes to fittings and tighten securely.
7. Use the instructions in the installation guide to make the pump ready for service.

### 4. Replacement of motorkit

#### Dismounting:

1. Follow directions for dismounting of the terminalbox.
2. Support motorhead before removal of the 8 screws at motorflange. Carefully pull out the motorhead and when free of pumpcase point impeller up.

#### Mounting:

1. Always replace O-ring between motorhead and pumpcase. Check impeller size and compare to old impeller.
2. Place the new O-ring on the bracket.
3. Fit motorhead in the pumpcase and tighten screws according to crosspattern.
4. Follow instructions for mounting of the terminalbox.
5. Use the instructions in the installation guide to make the pump ready for service.

### 5 Position of terminal box

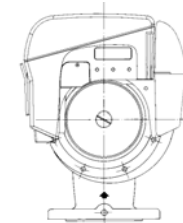

**In horizontal pipe system**

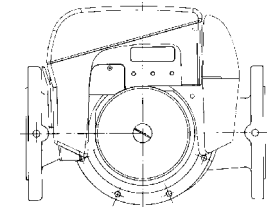

**In vertical pipe system**