

Omega™

Glanded pumps.
Tørløber pumper.
Trockenläufer Pumpen.

In-line DN 50

Omega 5-100-2
Omega 5-100-4

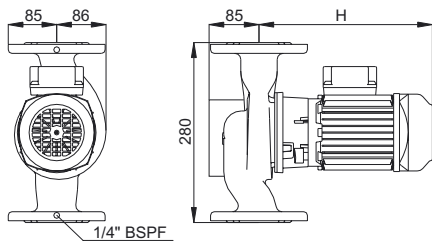
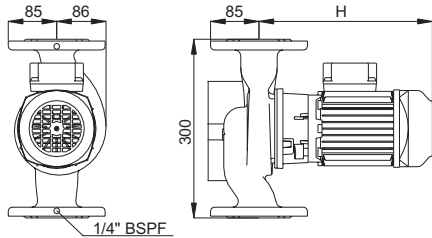

Option: 280mm port to port Length

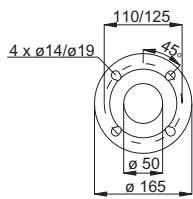

PN 6/10
DIN 2533

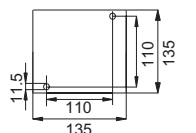

Foot: Single model

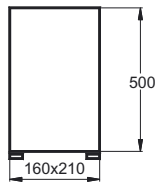

Pedestal 44 kg.
(incl. concrete)

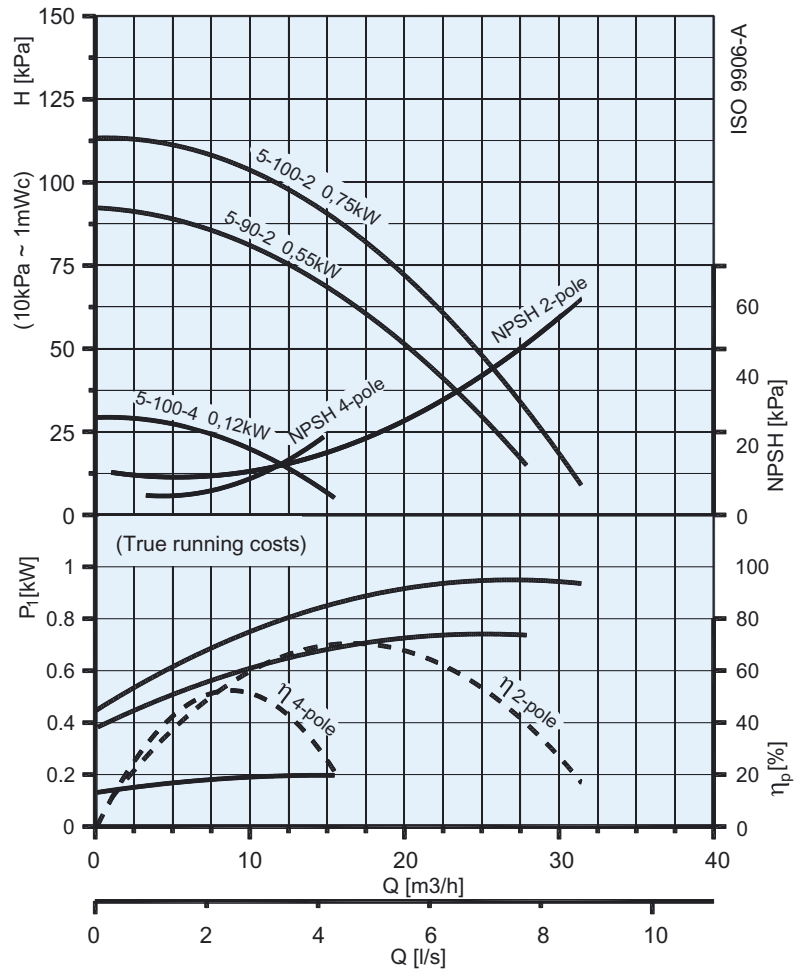

P_1 :

True running costs
Optagen effekt
Leistungsaufname

$$P_3 = Q \times H = \eta_p \times P_2$$

$$P_2 = \eta_m \times P_1$$

		0,12	0,55	0,75
H	Enkel	282	282	292
	Par	-	-	-

Type.	Kg		Motor P_2 (kW)	In (A) (50Hz) standard			Cos ϕ	n(min ⁻¹)	dB(A)	η_m (%) standard.		
	Single	Twin		1x230V	3x400/230V	3x690/400V				eff 1	eff 2	eff 3
Omega 5-100-4	16,4	-	0,12	-	0,5/0,87	-	0,67	1405	36	63	54	-
Omega 5-100-4	16,9	-	0,12	1,2	-	-	0,87	1420	36	54	49	-
Omega 5-90-2	17,9	-	0,55	-	1,6/2,8	-	0,70	2840	46	72	-	-
Omega 5-90-2	18,6	-	0,55	4,2	-	-	0,92	2710	46	72	65	-
Omega 5-100-2	18,5	-	0,75	-	2,0/3,46	-	0,83	2710	46	79	65	-
Omega 5-100-2	20,9	-	0,75	4,75	-	-	0,94	2810	52	74	-	-

IEC 38 +/- 10%, 50 Hz, IP 55

This model is also available as an Omega-Drive - a selfregulating pump with integral inverter and optional differential pressure transducer. Denne model fås også som Omega-Drive - en selvregulerende pumpe med integreret frekvensomformer med eller uden monteret differensstryk-transmitter. Dieses Model ist auch als Omega-Drive lieferbar - eine selbstregulierende Pumpe mit integriertem Umrichter, mit montiertem oder ohne Differenzdruckschalter.

Smedegaard reserve the right to change the product without prior notice and take no responsibility for inaccuracies or misprints.

SMEDEGARD
OF DENMARK